



## AM-M10 Dash Cam Manual

The AM-M10 is a full HD 1080P dash cam with functions including audio & video recording, G-sensor, parking monitor, one-button snapshot, Wi-Fi, App, video play-back & sharing. It features a Sony IMX 323 sensor. Please read this user manual carefully prior to installation. Please keep it in a safe place for your future reference.

To download the Camera App for your device, please follow the link that is applicable.

**Android:**

[https://play.google.com/store/apps/details?id=com.oneed.dvr&hl=en\\_GB](https://play.google.com/store/apps/details?id=com.oneed.dvr&hl=en_GB)

Or search for the App: CheyunDVR

**IOS:**

<https://itunes.apple.com/gb/app/cheyunforeign/id1181794872?mt=8>

Or search for the App: CheyunForeign

If you have any questions, please contact us at:

[Suport@amacam.net](mailto:Suport@amacam.net)

[www.amacam.net](http://www.amacam.net)

## ➤ Structure and part description:

### 1 ) Dash camera:

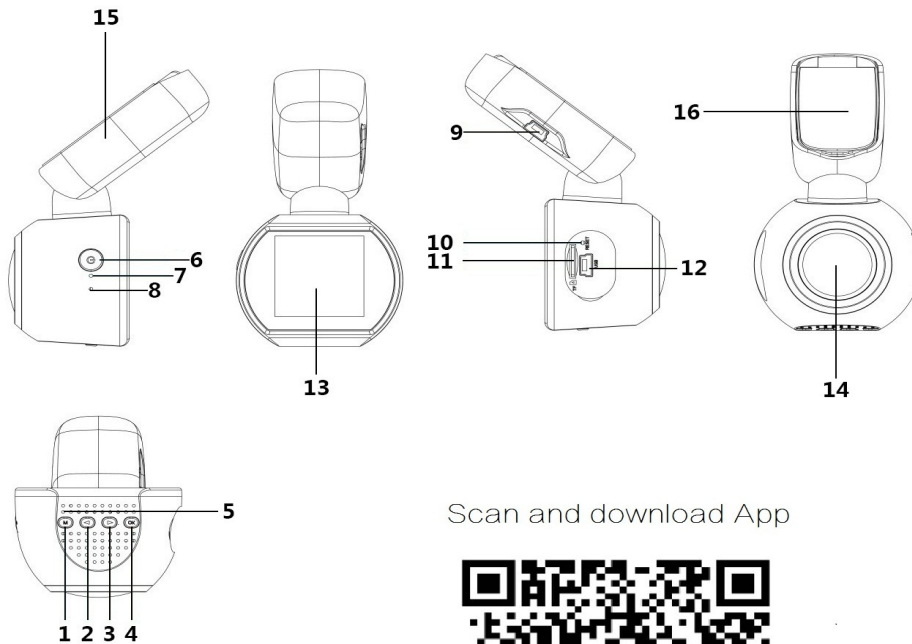

Scan and download App



- |                |                   |                     |                     |
|----------------|-------------------|---------------------|---------------------|
| 1) Menu button | 2) Page up button | 3) Page down button | 4) Enter button     |
| 5) Speaker     | 6) Power button   | 7) Microphone       | 8) Indicating light |
| 9) USB 1       | 10) Reset button  | 11) TF card slot    | 12) USB 2           |
| 13) Screen     | 14) Lens          | 15) GPS             | 16) 3M mount        |

### 2 ) Remote control :

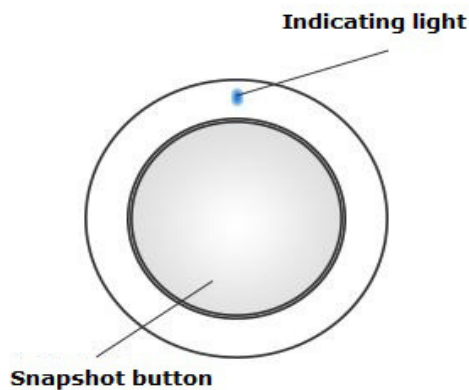

## ➤ **Pairing the camera and remote control:**

Turn the camera on, insert the battery into controller and press the controller button and hold. The indicator light will flash for 3-5 seconds indicating the pairing process is taking place. When the light stops flashing, press the button once again and the camera snapshot sound is heard. Pairing is complete. If pairing is not complete, please try again. If blue light is not on, it means low battery power. Please replace the battery.

## ➤ **Button description:**

### **1) Menu button:**

#### **Function 1: Menu**

Under Standby mode, short press on **【Menu button】** to enter main menu. Short press on **【Page up button】** or **【Page down button】** to select options, short press **【Menu button】** to shift between menu categories and short press on **【Enter button】** to enter. Upon completion of setup, short press on **【Menu button】** to exit menu setup. (Menu setup is same under picture mode and play-back mode, but not available under video mode)

#### **Function 2: Video file protection**

Under video mode, short press on **【Menu button】** to start file protection recording. A locked file icon will appear on screen. Video footage recorded will be saved and locked and will not be overwritten.

#### **Function 3: Mode**

Under standby mode, short press on **【Menu button】** to shift between different modes (video/photo/video play-back/photo play-back).

### **2) Page up button:**

### **Function 1: Page up**

Under menu setup and play-back mode, page up

### **Function 2: Fast rewind**

Under play-back mode, short press on **【Page up button】** for fast

## **3) Page down button:**

### **Function 1: Page down**

Under menu setup and play-back mode, page down

### **Function 2: Fast forward**

Under play-back mode, short press on **【Page down button】** for fast forward

## **4) Enter button:**

### **Function 1: Turn on/off video recording**

Under video mode, short press on **【Enter button】** to start taking video, another short press on **【Enter button】** to stop taking video.

### **Function 2: Photo taking**

Under photo mode, short press on **【Enter button】** to take photo

### **Function 3: Video play**

Under file browse mode, short press on **【Enter button】** to play video

### **Function 4: Enter**

Under standby/video/photo/play-back mode, short press on **【Menu button】** to enter menu, short press on **【Page up button】** or **【Page down button】** to browse, short press on **【Enter button】** to enter.

## **5 ) Power button:**

To turn the camera on and off : When the camera is off, short press on **【Power button】** this

will power up the camera. When the camera is on, press the **【Power button】** and hold it for 3 seconds. The video footage and camera settings are saved and the camera is powered off.

#### **6) Reset button:**

Press the **【Reset button】** to reset the camera should it ever lockup.

Then press **【Power button】** to restart the camera.

### **➤ Function description:**

**1 ) Video recording:** Install the memory card, turn the camera on and it will start recording. The indicator light will flash and the REC icon appears on the screen. Press **【Enter button】** to stop recording. The indicator light will be on and the STBY icon will show on the screen.

**2 ) Taking pictures:** Under standby mode, short press on **【Menu button】** to enter photo mode. The DVR icon on upper left corner of screen changes to the camera icon. Short press on **【Enter button】** to take a photo. To switch back to video mode, short press on **【Menu button】** twice.

**3 ) Play-back: Play-back:** Under standby mode, press on **【Menu button】** twice to enter play-back mode. Press on **【Page up button】** or **【Page down button】** to select video footage, press **【Enter button】** to play. Under play mode, press **【Enter button】** to pause, press on **【Page up button】** or **【Page down button】** to fast forward or fast rewind.

**4 ) G-sensor:** When a collision occurs, the built-in G-sensor activates the file protection option. The video footage is saved and locked. The lock icon appears on the screen. The locked video footage will not be overwritten. Remarks: G-sensor sensitivity is adjustable from menu.

**5 ) Video file protection:** One-button file lock function will protect the video footage so it will not be

overwritten. Under video mode, short press on **【Menu button】** to lock the video file.

**6 ) Parking monitor:** When the camera is off, if the lens detects any movement, the camera will begin recording automatically. The video footage is then saved and locked. If there is no movement within a further 10 seconds, the camera will stop recording.

**7 ) Cycle recording:** The oldest video footage will be overwritten by newer files. Cycle recording setup can be done from the video mode menu.

There are six options: Off /1 minute/2 minutes/ 3 minutes/5 minutes/10 minutes.

**8) Audio recording while video is recorded:** Audio on/off

**9) Date and time setup:** Under standby mode, short press on **【Menu button】** to enter system setup menu, short press the **【Page up button】** or **【Page down button】** to move the cursor to date setup options. Short press the **【Enter button】** to enter menu setup.

Remarks: Please make sure the correct date and time is set up so as to ensure valid video footage as evidence in case of accident.

**10 ) USB mode:** Connects the camera to a PC via the USB cable. Two modes will be shown on screen, USB and camera. Short press on **【Page up button】** or **【Page down button】** to select USB option, then short press on **【Enter button】** to enter USB mode.

**11 ) Charging the battery:** Plug in the power cable, and the red indicator light will be on, indicating the battery is charging. The red light dims as battery charges up. When fully charged the red light will turn off.

**12 ) Screen off delay:** The screen can be turned off automatically. In the menu select “Screen off timing”. There are four options are available: Off/3 minutes/5 minutes/10 minutes. For example, “3 minutes” option would mean dash cam goes to power saving mode after dash cam is turned on for 3 minutes and then screen is off. Default setting is “Off”.

**App:** Under standby mode, short press on **【Menu button】** to enter menu, short press on **【Menu button】** again to switch to system setup. Select WIFI, short press on **【Enter button】** to view SSID and PSW. Under mobile phone setup menu, connect SSID, run App to browse, view or play-back video.

### ➤ **Installation guide:**

- 1 ) Ensure that the camera is turned off
- 2 ) Insert a Class 10 or above memory card with a capacity at least 8G. Please ensure that the card has been formatted using the camera facility.
- 3 ) Fix the camera on windscreen using the adhesive mount.
- 4 ) Plug in the car charger to car auxiliary socket.
- 5 ) Connect USB connector to the camera.
- 6 ) Adjust lens position, and make sure nothing obstructs the view.
- 7 ) Switch the ignition on and start the car. The camera will automatically begin recording and the REC light will be on.

You have now successfully installed your AM-M10 Dash Camera.

### ➤ **Specifications:**

Chip-set	MSTAR MSC8328P
Sensor	SONY IMX323
Screen	1.54 inch
Video format	MP4
Picture resolution	2048*1536
Snapshot resolution	1920*1080
Picture format	JPG
Memory card	Support TF card up to 64 G

LDWS	Supports
FCWS	Supports
GPS	Supports
Remote controller	Supports
WDS	Supports
USB type	USB2.0
Power supply port	USB2.0 DC5V 1A
Frequency	50HZ/60HZ
Battery	140mAh 3.7V lithium battery
Current	450mA
Mic/speaker	Supports
Language	Simplified Chinese/English/French/Japanese

Remarks: Specification is subject to change due to factors including system upgrade

### ➤ **Remarks:**

- 1 ) Please use authorised power adapter only. Use of unauthorised power adapter could cause damage to the camera
- 2 ) Avoid use of the camera in humid or high temperature environment
- 3 ) Keep the lens clean to avoid poor quality video recordings
- 4 ) Do not attempt to open the camera, this will void your warranty
- 5 ) Illegal use of the camera is prohibited

### **Firmware Version & Update**

Press the “POWER” button twice to enter “Set Up Menu” Select “Version”, Check the version number. The latest version can be downloaded here>>>

[www.amacam.net/support/firmware-update](http://www.amacam.net/support/firmware-update)

### **Registration**

To keep up to date with the latest Firmware, please ensure that you register your Amacam AM-M10 here>>>

[www.amacam.net/product-esistration](http://www.amacam.net/product-esistration)